

This trendy railing offers a change of perspective depending on the angle. Elegant and sturdy, it looks great in shared sites.

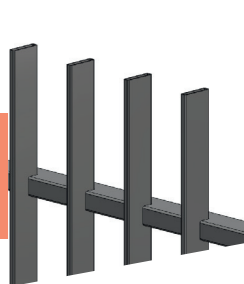

50×10mm bars partially integrated into the bracing rail



Invisible connections

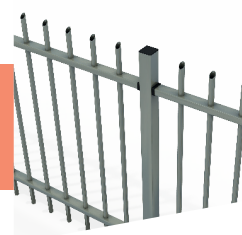

Round or square posts

CHOICES AND MODULAR DESIGN

- Heights: 1.00 to 2.50m.
- 60×60mm square posts or 60mm dia. round posts, drilled or undrilled.
- Embedded or base-plated.

SECURITY

- Protection that is subtle and stylish.
- Screws are inaccessible after installation.

STYLE

- The modern, dynamic design will enhance the entire site.
- Straight railings with flat iron effect, creating a sense of rhythm and perspective.
- Round or square posts to suit any architectural style.

FINISH

- Slotted assembly with invisible connections.
- Rail end caps to conceal cuts.
- Stainless steel connection accessories resistant to corrosion.

EASY INSTALLATION

- Installation in forward sequence.
- Steps can be precisely adjusted with undrilled posts.
- Angle management made possible thanks to the connection systems.

●●●○
BUDGET

●●●○
SECURITY
LEVEL

●●●○
DESIGN

●●●●●
EASY
INSTALLATION

HOUSING
COMPLEXES



PUBLIC AREAS



SERVICE SECTOR
SITES



GENERAL CHARACTERISTICS

→ Railings:

Rail: 50 × 30mm,
Hollow overstanding bars: 50 × 10mm,
Spacing between bars: 110mm max.,
Flat cut bars.

→ Posts:

60 × 60mm square posts or 60mm dia. round posts,
embedded or base-plated, drilled or undrilled.

→ Connection accessories (4 per post):

Stainless steel "U",
Self-tapping screw,
Square or round post end cap.

→ 6 standard colours:

• Green 6005, Grey 7016, Grey 7030, Grey 7035,
Black 9005, White 9010.

→ 200 RAL colours.

→ Anti-corrosion treated Sendzimir steel finish with polyester coating.

→ Optional matt and textured coatings.

→ "PROTECT+" coatings for the most corrosive areas.

TECHNICAL INFORMATION

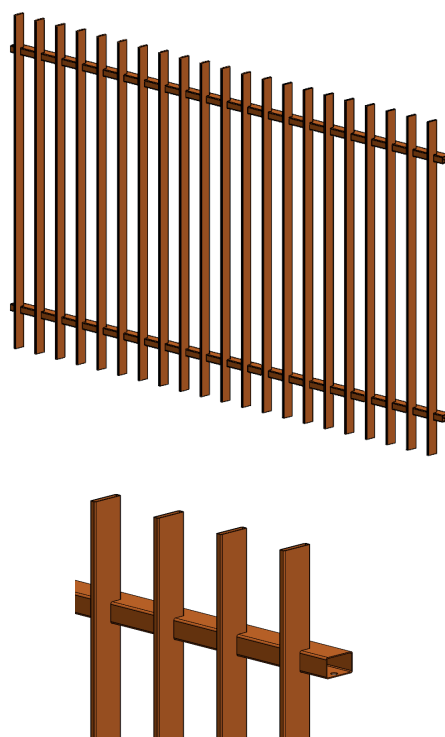
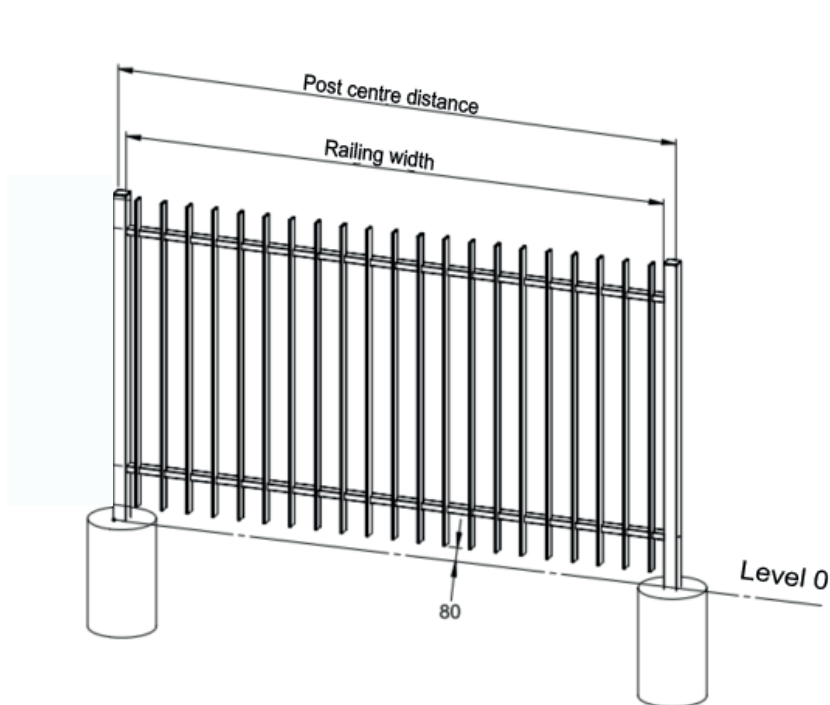

Nominal height (m)	Railing width (m)	Post centre distance (mm)	Number of bars	Bar length (mm)	Space below railings (mm)	Hollow square bars (mm)	Bar thickness (mm)	Spacing between bars (mm)
1.00	2.510	Axial posts: - Round posts = 2570 - Square posts = 2575	21	920	80	50×10	1.5	110
1.20				1120				
1.50				1420				
1.80				1720				
2.00				1920				
2.30	2.270	Offset posts: - Round posts = 2518 - Square posts = 2278	19	2220	80	50×10	1.5	110
2.50				2420				

INSTALLATION CONFIGURATION

→ **Embedded:**
Must be embedded to a depth of 50cm.

→ **Base-plated:**
Suitable for installation on a wall or paved ground, and avoids boring into concrete.

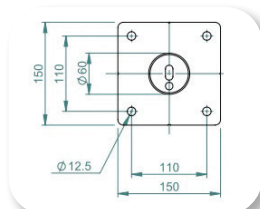

→ **Corners:**
Use an undrilled post.

→ **Stepped:**
Use longer, undrilled posts.
The connection system allows for adjustments to the millimetre.



→ Assembly is achieved by slotting railings into the posts:

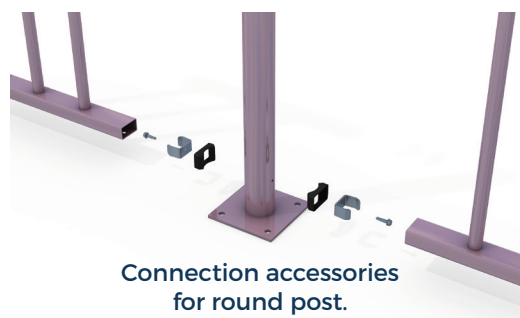

→ **Angle management:**

- On round post:
angle of 90° to 180°.

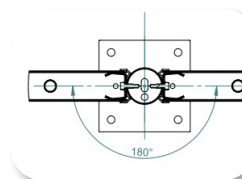
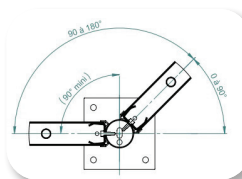
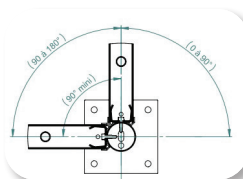

- On square post:
angle of 50° to 180°.

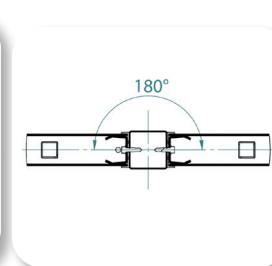
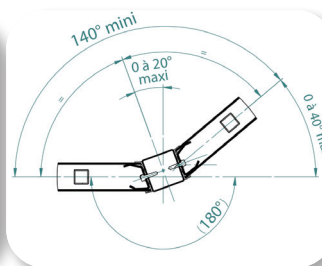
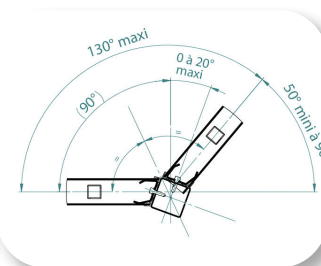
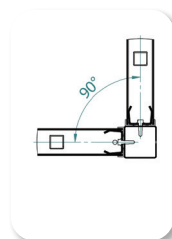

INSTALLATION CONFIGURATION

TIP

The offset post is discreet and blends in perfectly with the railings. Bars positioned at the ends offer a sense of continuity as the centre distance between them and the other bars on the railing is identical.

To offset the post, use the accessory provided.
For use on square posts only.

For a perfect finish, align the post with the top rail by embedding it 14.5cm deeper into the ground.

Offset post installation available as of March 2021.

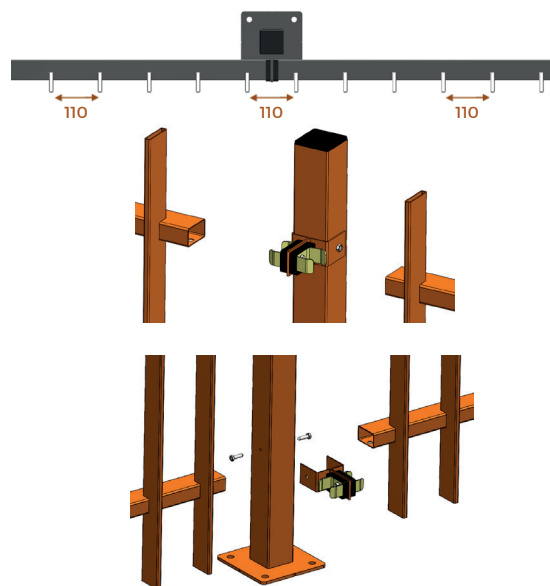

OPTIONS & ACCESSORIES

- Triple or quadruple rail.
- Caps for the bars.
- Additional connection accessories (in case parts need to be cut to size).
- Double U-shaped bracket unit to be fastened to the post for offset installation (available as of March 2021).

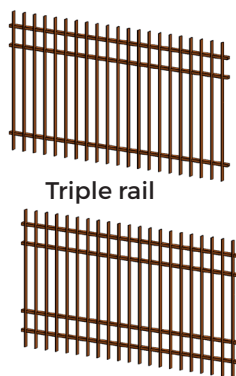

Triple rail

Quadruple rail

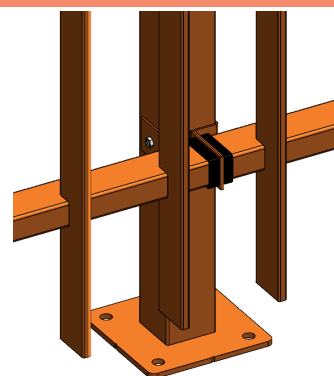

Accessory for offset installation

ADDITIONAL PRODUCTS

- Matching gates:

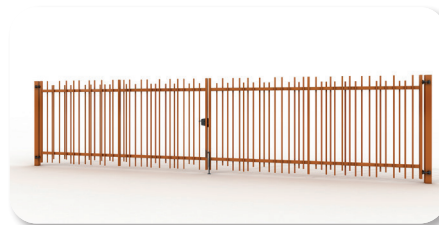

- LEXIE decorative sheet metal:

